

Cellular Shade (Cordless & Cord Loop Clutch)

Installation Instructions

Please follow these Installation Instructions

You will need a pencil, tape measure, drill, screwdriver, pliers, and appropriate fasteners.

Step 1: Choose the Correct Fastener

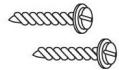

1 1/4" #8 Hex Head
Wood Screws (Included)

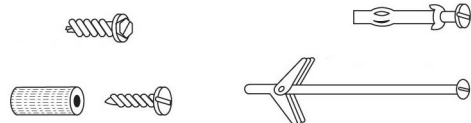

Alternative fasteners should be used for aluminum or
concrete installations
{Not Included with Blinds}

Step 2: Mark the Bracket Locations

Shade with
Cord Loop Clutch

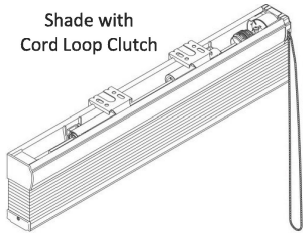

Position the first two installation brackets so that they are approximately 4" in from the end of the headrail. If a third bracket is included, center it between the outer brackets. Wide shades may include up to 8 brackets. In these cases, space the additional brackets evenly, not more than 25" apart. Mark the brackets for mounting hole locations, making sure they are square and equally spaced. For outside mount installations, use a level to check for levelness.

Cordless

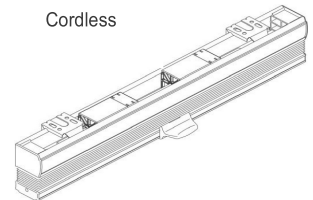

Step 3: Bracket Installation

(For Outside Mount Installations)
Screw brackets into wall as shown.

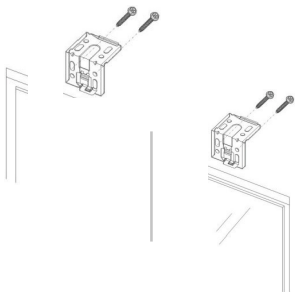

(For Inside Mount Installations)
Screw brackets in window frame

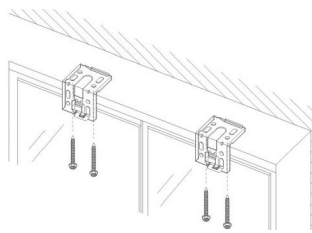

Step 4: Shade Installation

Hang the shade so that the front groove of the headrail is inserted into the front ridge of the bracket. Rotate the shade back towards the back end so that the headrail snaps into place. Make sure that the shade is locked in place.

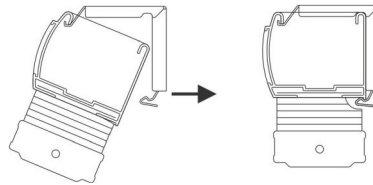

Step 5: Safety Tension Device Installation



Safety Tension Devices are designed to minimize the hazards of strangulation and entanglement of small children by restricting access to the chain control. The safety tension device is sent from the factory already attached to each chain control. Screw the safety tension device into the wall or window frame with a screw.

Critical Note: The safety device should be installed so that the bead chain and bead stop balls move smoothly through the opening of the device. Removal of this device or failure to properly install it, can cause damage to the clutch lifting mechanism and will result in the voidance of warranty.

Operating Instructions:

Shades with Cord Loop Clutch

To lower the shade, pull the back cord straight down until the shade reaches the desired location and then release.

To raise the shade, pull the front cord straight down until the shade reaches the desired location and then release.

Cordless Shade

To lower or raise the shade, grasp the handle attached to the bottomrail and adjust the shade up or down until the shade reaches the desired location and then release.