

# A Better Blind Clutch Window Shade Installation Instructions

## Step 1: Mount the brackets

If the clutch is on the right end of the shade, attach the brackets to the window frame, window molding, wall or ceiling, as shown below. If the clutch is on the left end of the shade, reverse the bracket positions, left or right.

To the inside of the window frame:

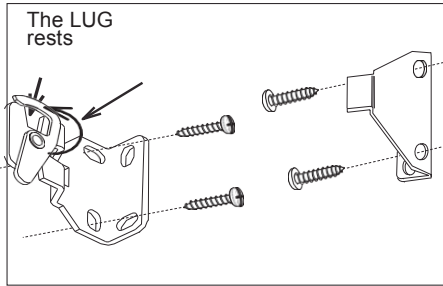

To the wall or front of the window frame:

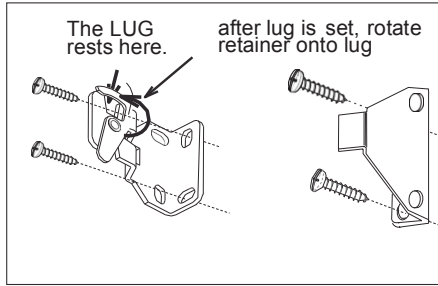

To the ceiling or top of the window frame:

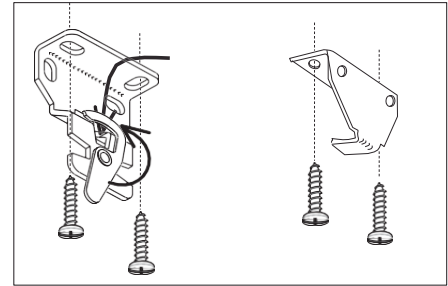

## Step 2: Install the shade

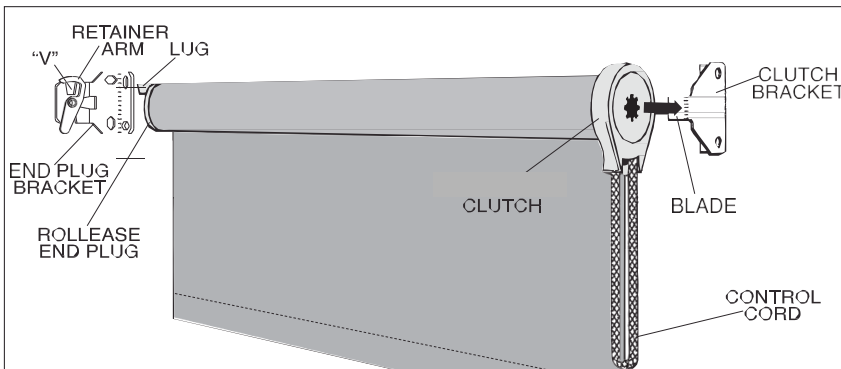

a. Push the clutch straight onto the blade of its bracket. The bottom of the clutch should always point straight down.

b. Lower the lug of the end plug onto the "V" of its bracket. The roller should fit in the brackets securely, with just a little play. Rotate the riveted retainer portion to lock the lug in position.

## Step 3: Install the tension device



## Step 4: Use the chain to operate the shade.

Pulling gently on the chain in one direction raises the shade; pulling it in the other direction lowers it.

## Step 5: Attach stops

On metal bead chain, attach a metal stop ball that is supplied with hardware, so that it touches the mouth of the clutch when the shade is in the all-rolled-up position.

For metal or plastic bead chain, lower the shade to sill or floor height, and attach the appropriate metal stop or plastic connector next to the clutch, this prevents the shade from being lowered beyond that point.